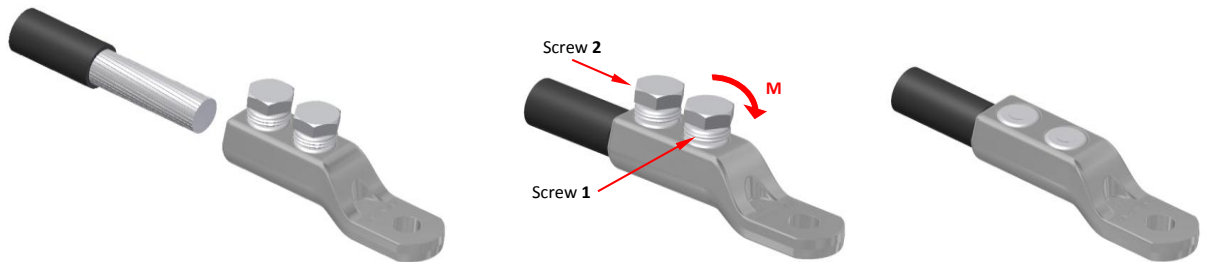
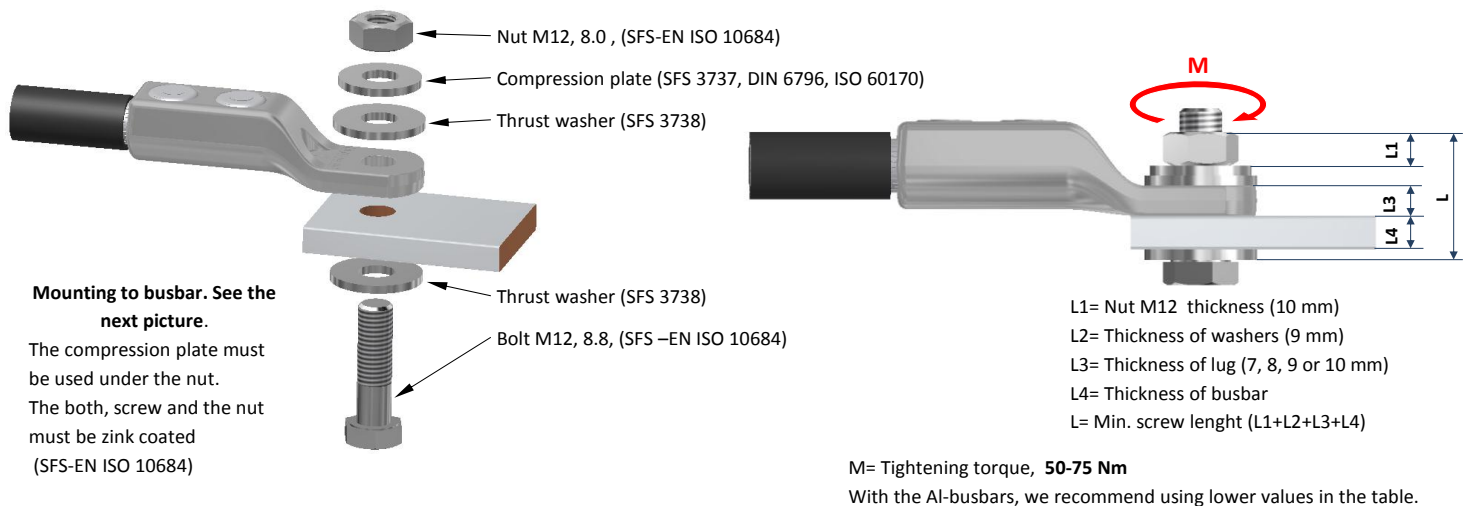

Product data						
Product code	Product name	Bolt	SW	Torque M	Stripping length L	Max. Cross-section A
VB05-0001	Shear bolt cable lug ROLA 10-50	M10x1	10	7-10 Nm	32 mm	50 mm ²
VB05-0002	Shear bolt cable lug ROLA 25-95	M14x1,5	14	21-27 Nm	44 mm	95 mm ²
VB05-0003	Shear bolt cable lug ROLA 95-185	M18x1,5	18	36-43 Nm	53 mm	185 mm ²
VB05-0004	Shear bolt cable lug ROLA 185-300	M22x1,5	22	48-56 Nm	69 mm	300 mm ²
	Un 1000 V					

Installation

ROLA cable lugs can be used for both **copper- or aluminium** conductors. With Al-conductors, it's recommended to use anti-corrosion paste (i.e. Penetrox)
 Strip the conductors, see the stripping lengths above. Insert conductor inside the cable lug and make sure that conductor is in bottom.
 Pre-tighten the screws: First screw 1, make sure that conductor does not move, then pre-tighten screw 2.
 Finally, The required torque is achieved by tightening the bolt until it breaks off. Screw 2 first.

Connection

Cross-section of conductors and number of conductors/ space. (Al-conductors in parenthesis)

	1,5 mm ²	2,5 mm ²	6 mm ²	10 mm ²	16 mm ²	25 mm ²	35 mm ²	50 mm ²
Shear bolt cable lug ROLA 10-50	-	-	-	3 (1)	3 (1)	2 (1)	1 (1)	1 (1)
Shear bolt cable lug ROLA 25-95	-	-	-	-	-	3 (1)	2 (1)	1 (1)
Shear bolt cable lug ROLA 95-185	-	-	-	-	-	-	-	-
Shear bolt cable lug ROLA 185-300	-	-	-	-	-	-	-	-
	70 mm ²	95 mm ²	120 mm ²	150 mm ²	185 mm ²	240 mm ²	300 mm ²	400 mm ²
Shear bolt cable lug ROLA 10-50	-	-	-	-	-	-	-	-
Shear bolt cable lug ROLA 25-95	1 (1)	1 (1)	-	-	-	-	-	-
Shear bolt cable lug ROLA 95-185	-	1 (1)	1 (1)	1 (1)	1 (1)	-	-	-
Shear bolt cable lug ROLA 185-300	-	-	-	-	1 (1)	1 (1)	1 (1)	-